

CMAA ANNUAL CONF

10/27/24 - 10/29/24

MARRIOTT MARQUIS - GOLDEN GATE BALLROOM - SAN FRANCISCO, CA

REVISION

Date: 4/12/2024

By: Yazmin Velazquez

BOOTH COUNT

Inventory as of 04/12/2024

Dimension	Size	Qty	SqFt
10'x10'	100	83	8,300
Totals:		83	8,300

BLDG. LEGEND:

CEILING HEIGHT: 9'-6".
 DENOTES PILLAR. ■
 DENOTES PILLAR. ■

DRAWING INFO

Passport Line Item Number:

#12665271

Facility:
MARRIOTT MARQUIS

Facility Location:
GOLDEN GATE BALLROOM
City & State:
SAN FRANCISCO, CA

Scale: CUSTOM

Project #: ----

Acct. Sales: CHRISTINE ROONEY

Acct. Mgmt.: ALEX WONG

Started: 4/12/2024

Started By: ENTER FULL NAME, STUDIO

Prod. Branch: SAN FRANCISCO

Freeman

Disclaimer - This floor plan is preliminary and subject to change pending review and official approval by all authorities having jurisdiction. Every effort has been made to ensure the accuracy of all information contained on this floor plan. However, no warranties, either expressed or implied, are made with respect to this floor plan. If the location of building columns, utilities or other architectural components of the facility is a consideration in the construction or usage of an exhibit, it is the sole responsibility of the exhibitor to physically inspect the facility to verify all dimension and locations.
 © Copyright 2024, Freeman Co. All rights reserved.

Confidential and Proprietary - the information contained herein is the proprietary information of Freeman and by accessing the information, the recipient agrees to keep the information confidential and not disclose it to any third party without the prior consent of Freeman. Recipient also agrees to only use the information for its internal evaluation purposes and for no other purpose, without the prior consent of Freeman.

FOURTH STREET

MISSION STREET

MARKET STREET

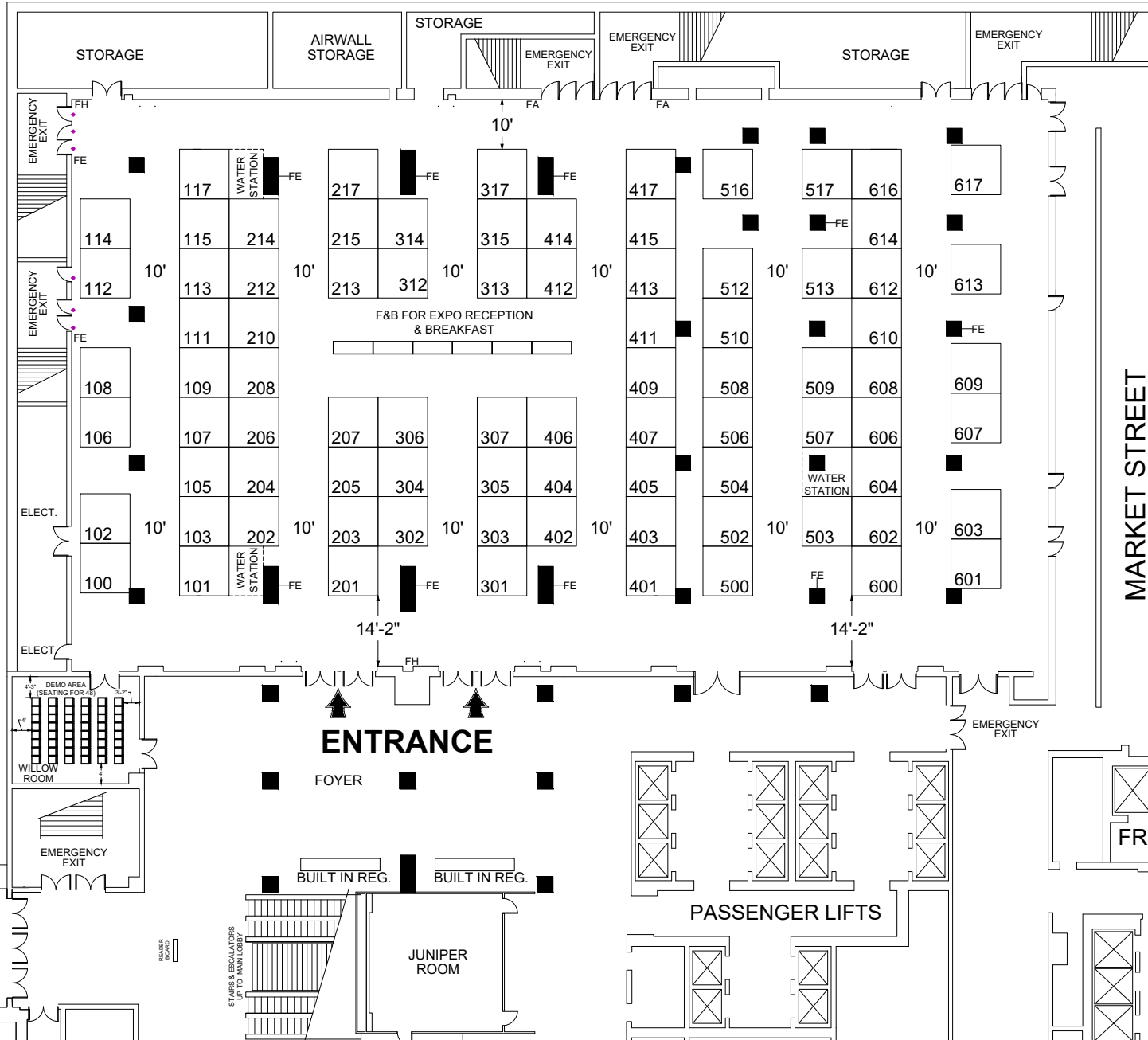

File Path: C:\Vault\Designs_Projects\Construction Mgmt Asn of Am Ann Conf\CMAA2410\Event\Floor Plans\CMAA24.dwg | Tab Name: L12665271 tp

Permanent Hotel Furniture
 12' Clearance From Door Required
 rel